

# ASSEMBLY INSTRUCTIONS

## HP-16 PAPERPOT TRANSPLANTER

*Turn hours of labor into minutes!*

Thank you for purchasing the Paperpot Transplanter! Purchasing the Paperpot Transplanter is like buying another employee - one you don't have to pay and always works.

Read these instructions in full before assembling the unit and please keep these instructions for future reference. You can also watch a video tutorial at [paperpot.co/instructions](http://paperpot.co/instructions).

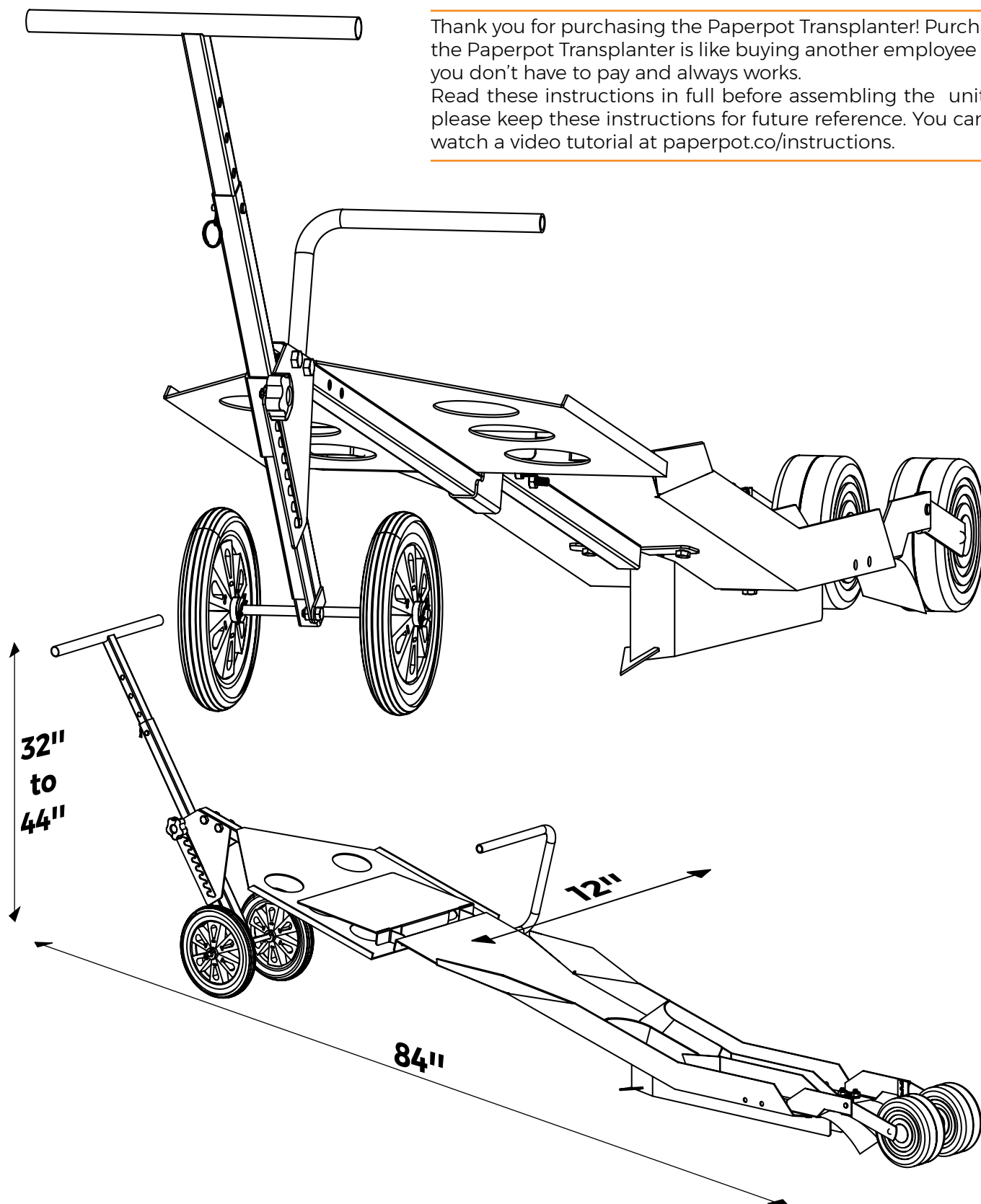

# PRODUCT PARTS

First identify all the parts and hardware. Do not discard any of the packaging until you have checked that you have all of the parts and hardware required. If for any reason you encounter a problem when assembling this item, please identify the part concerned on this page and contact us for help - [hello@paperpot.co](mailto:hello@paperpot.co).

**Note:** All hardware comes pre-attached to the parts.

1. Pull Handle
2. Front Wheels
3. Ramp
4. Pan
5. Carry Handle
6. Main Body
7. Sweep Right
8. Sweep Left
9. Rear Wheel Left
10. Rear Wheel Right
11. Wrench 10-13 (x2 pcs.)

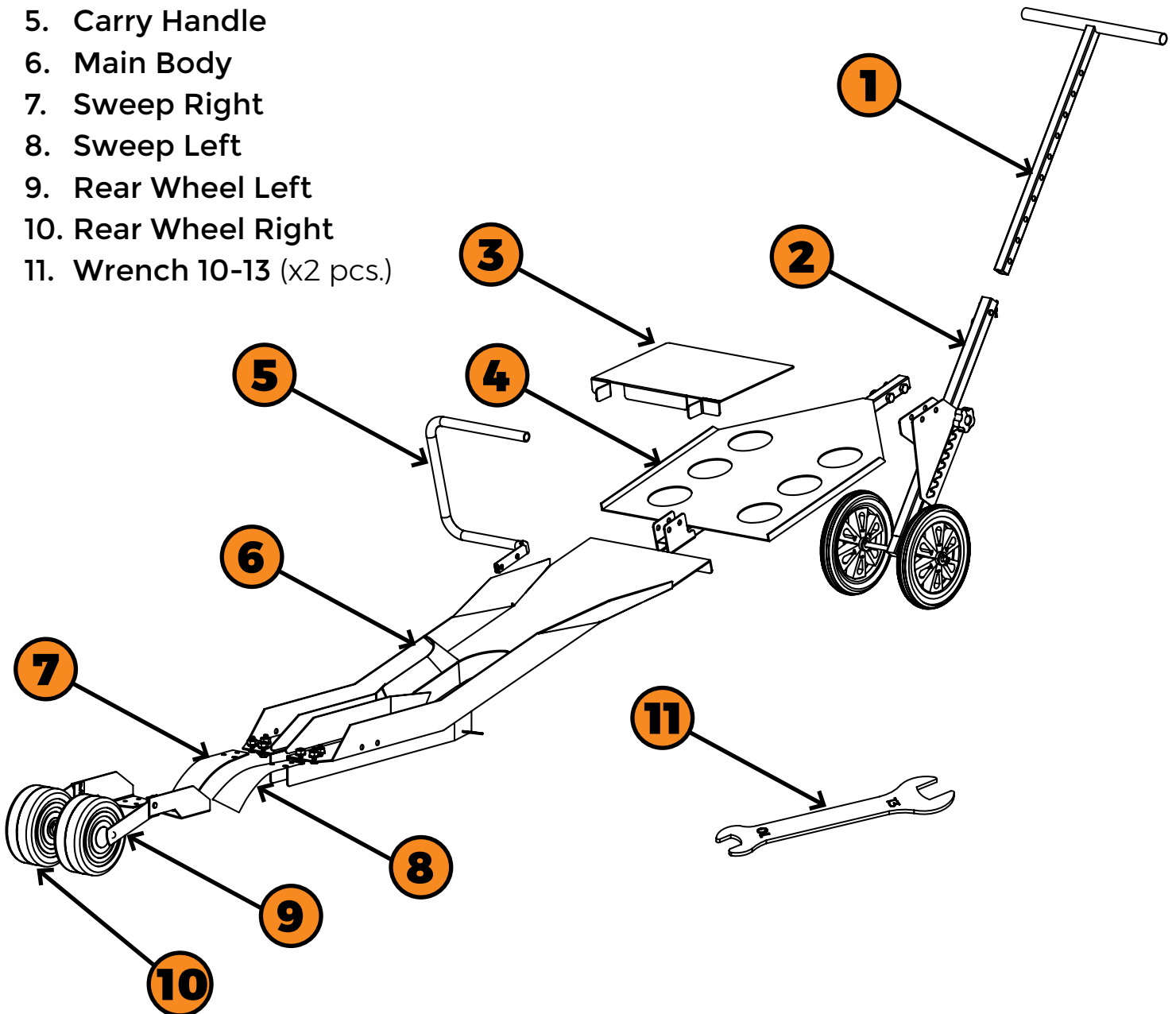

# ASSEMBLY INFORMATION

Assembly of your new HP-16 transplanter is straightforward and simple.

All bolts come pre-assembled on the transplanter in their final locations, you just need to remove the bolts to put the pieces together.

Although two wrenches are included with the unit, we recommend that you begin assembly with a socket wrench, a 13mm socket, a 10mm socket, and a crescent wrench or 10, 13mm wrench. These tools will help speed up the build.

**Notes:** During normal use bolts may loosen overtime. Periodically check that all connections are tight.

## Recommended tools

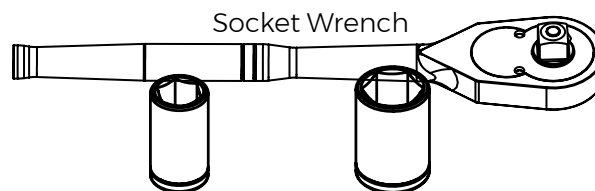
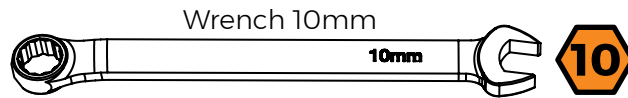

Socket 10mm

Socket 13mm

In total assembly should take less than 30 minutes for a single person, and having a second person will make the process easier and faster.

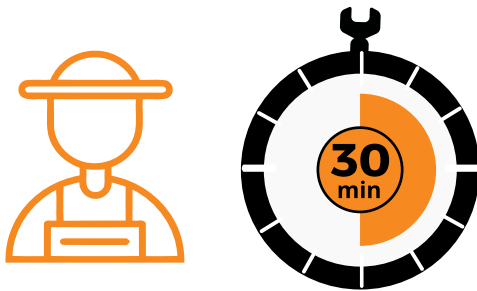

As you unpack and prepare for assembly, place the contents on a carpeted or padded area to protect them from damage.

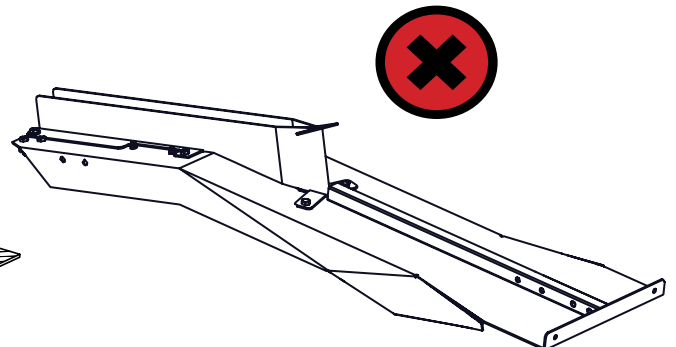
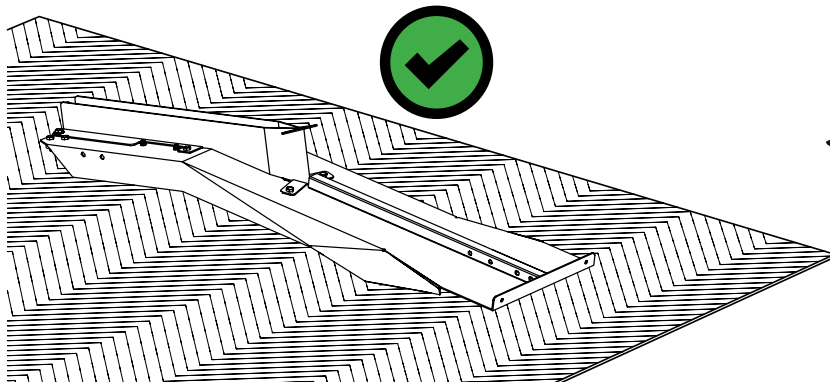

## STEP 1- Attach the Carry Handle (5)

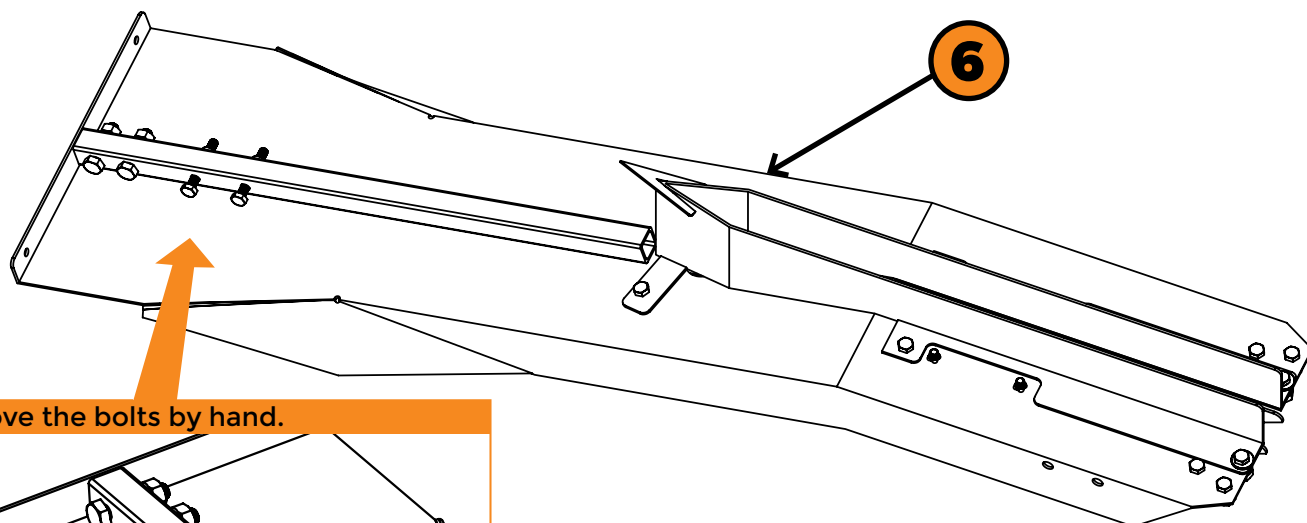

1. Remove the bolts by hand.

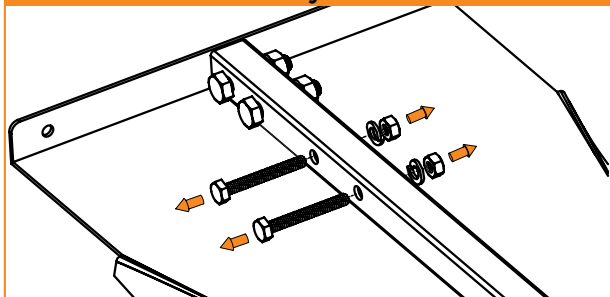

2. Position the Carry Handle and insert the bolts.

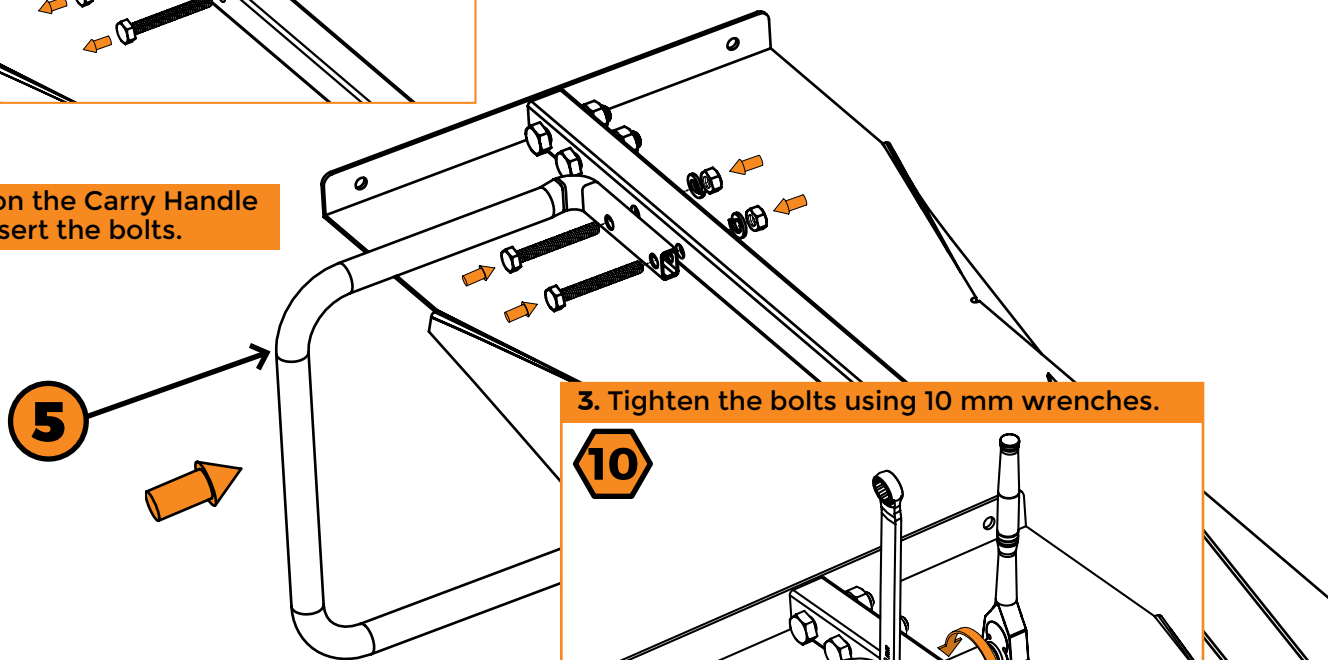

3. Tighten the bolts using 10 mm wrenches.

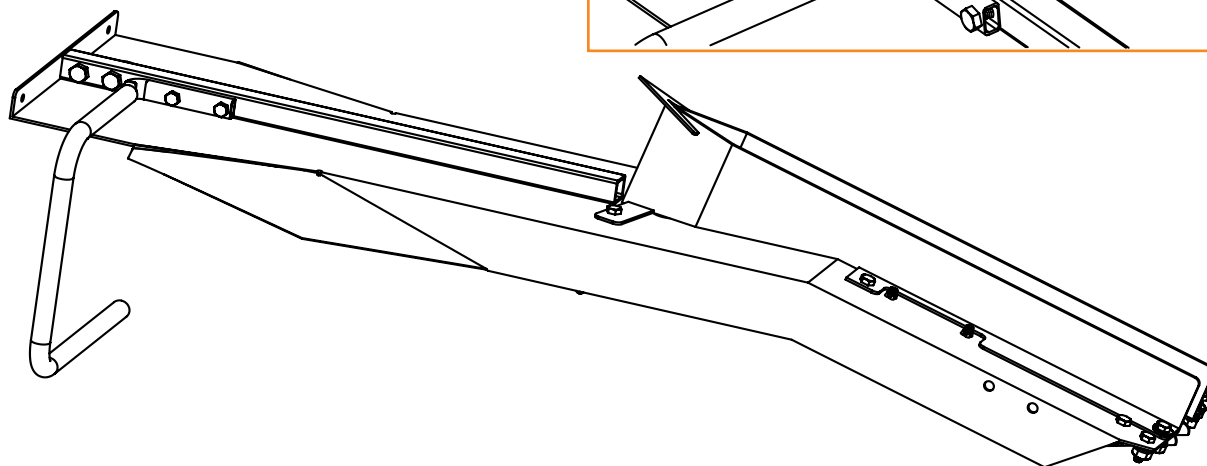
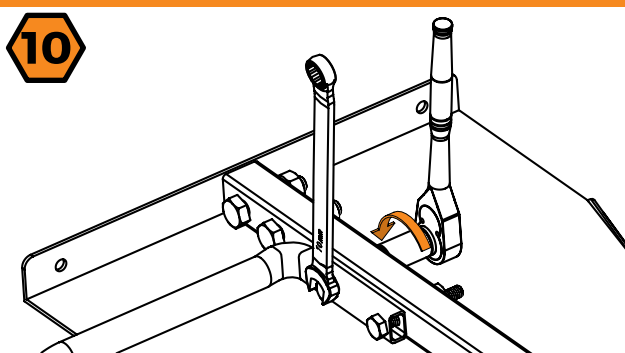

## STEP 2- Attach the Pan (4)

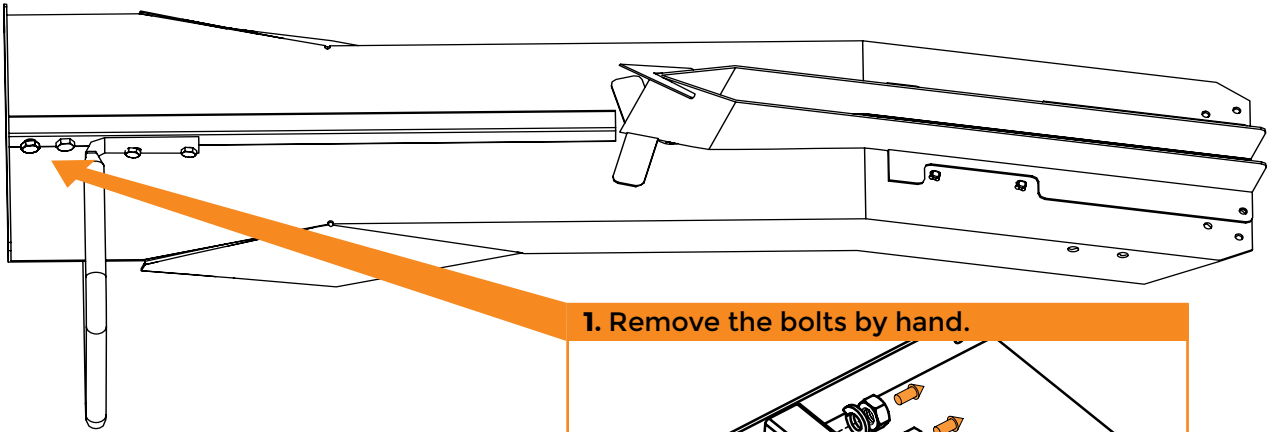

2. Attach the Pan to the Main Body.

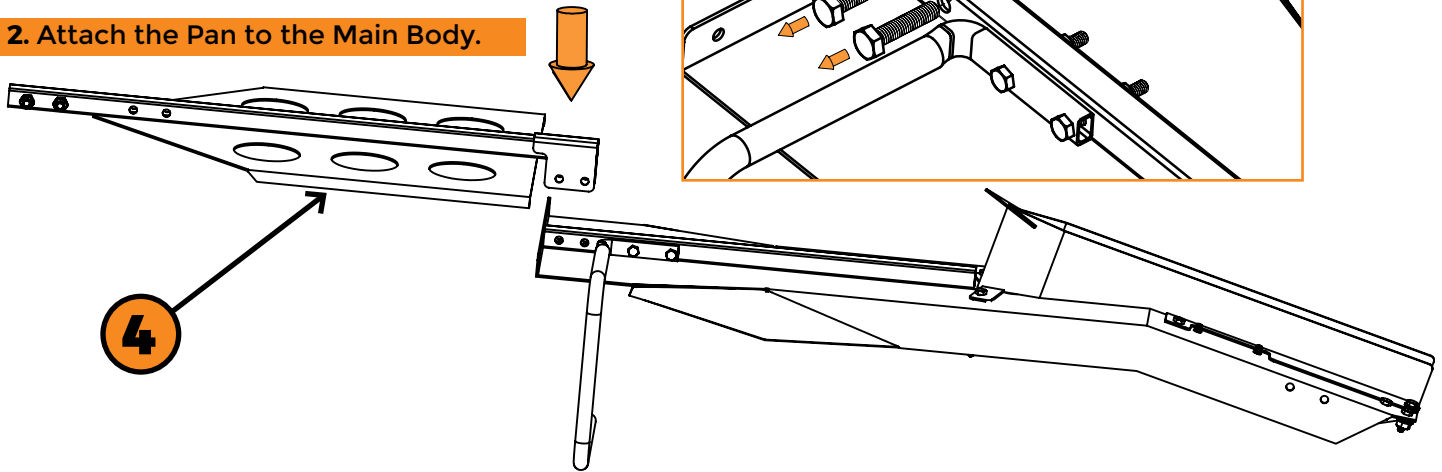

3. Insert the bolts to secure the connection.

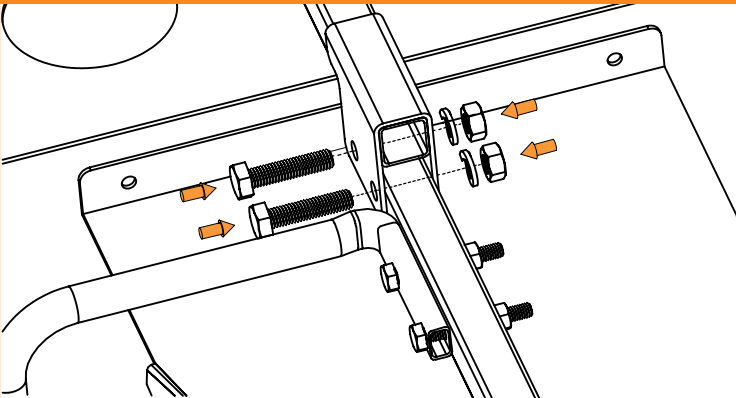

4. Tighten the bolts using 13mm wrenches.

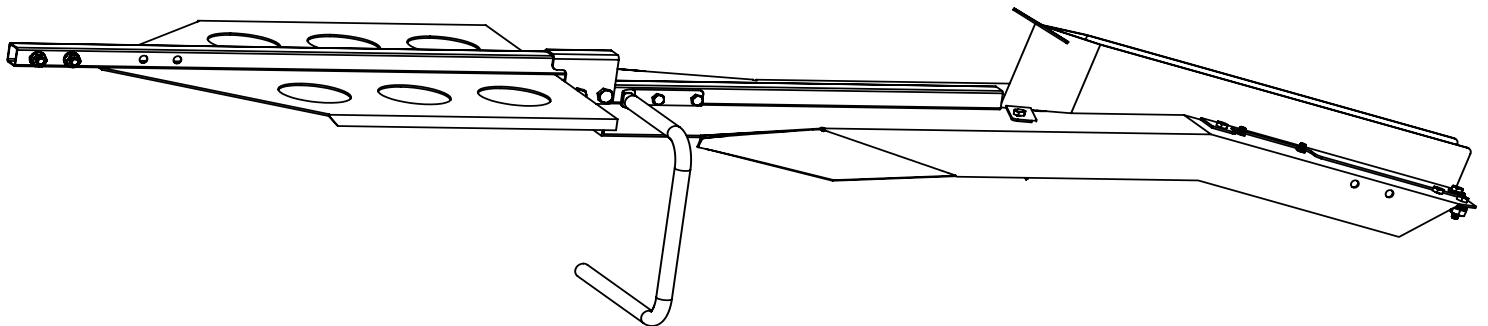
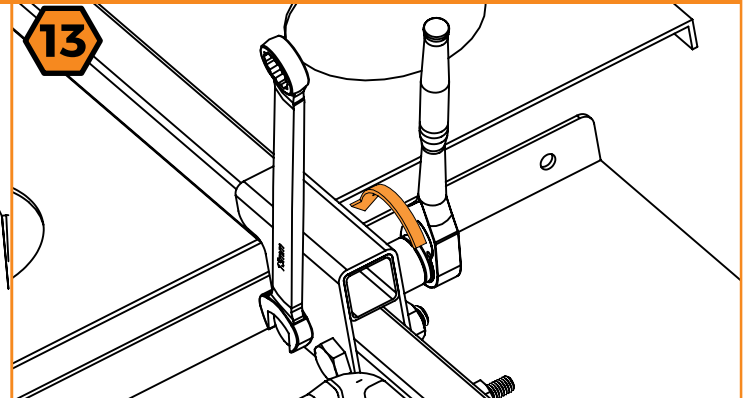

## STEP 3- Attach the Front Wheels (2)

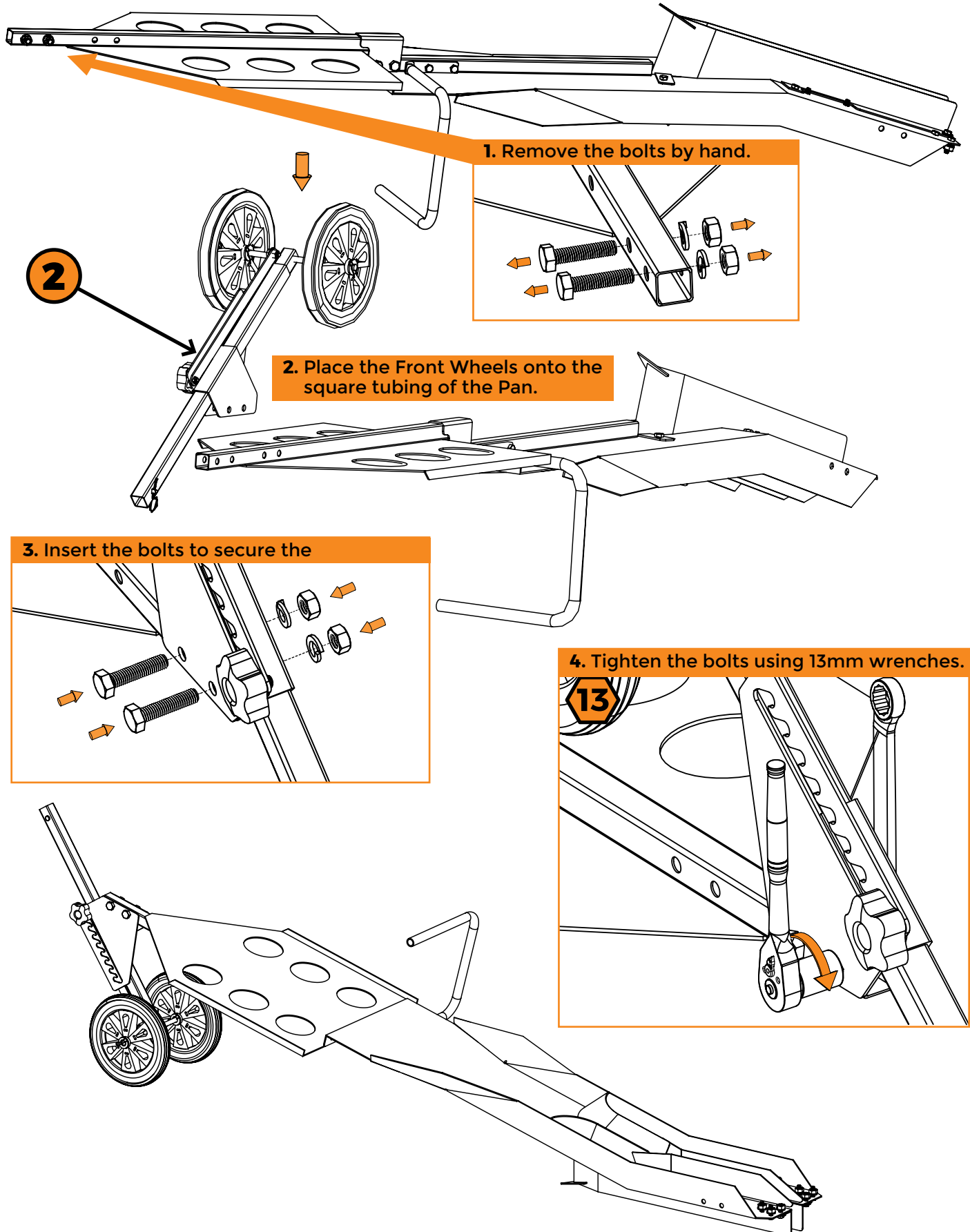

## STEP 4- Attach the Pull handle (1)

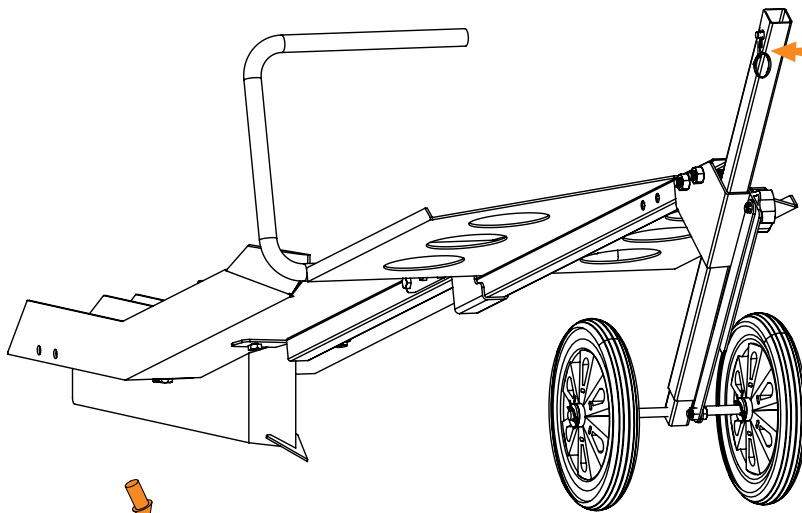

1. Pull out the Cotter Pin and then the Straight Pin.

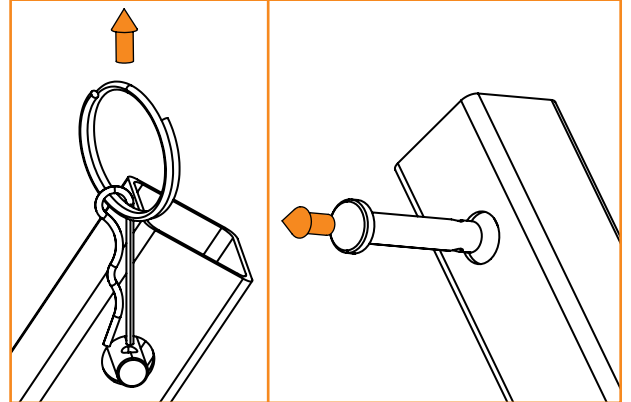

2. Insert the Pull Handle into the Front Wheel assembly and adjust the Handle height choosing 1 of the 10 holes.

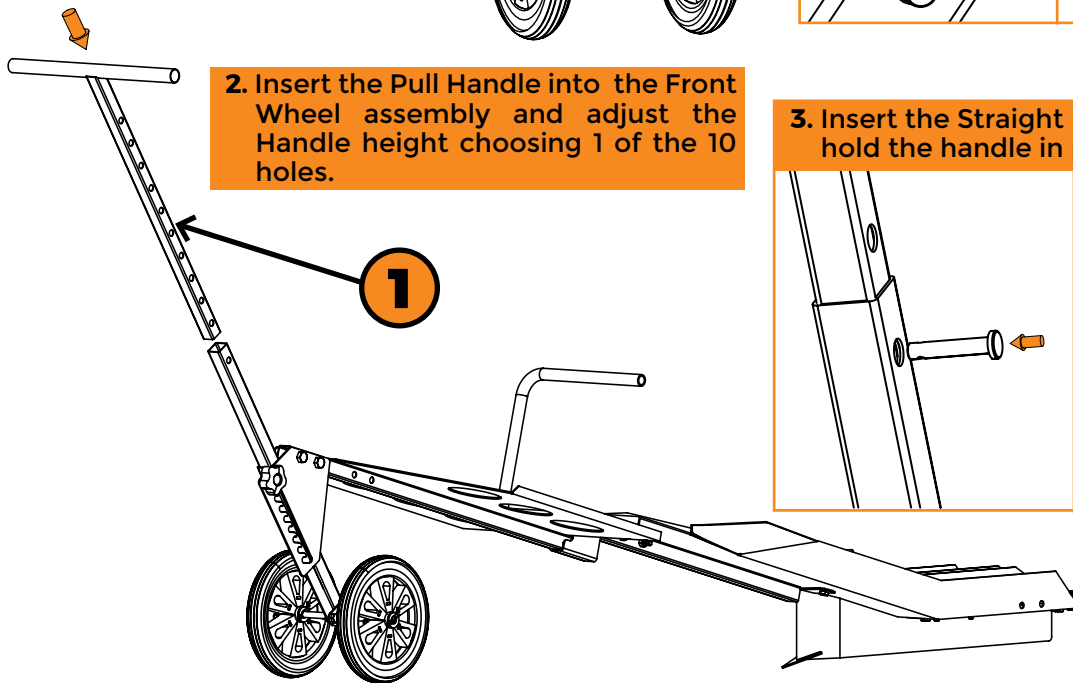

3. Insert the Straight Pin and the Cotter Pin to hold the handle in place.

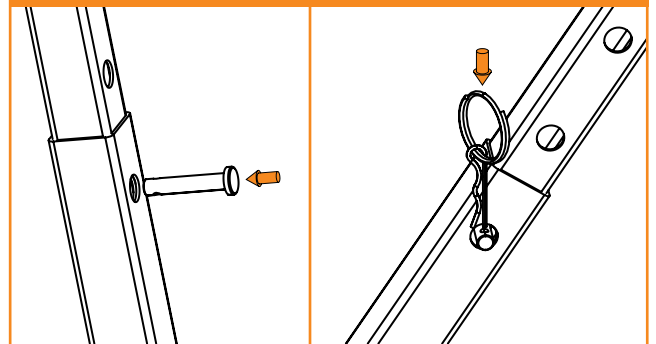

The Front Knob adjustment allows you to raise and lower the front of the unit which control the depth of the furrow and how deep the chain pots are placed in the soil. Position 1 creates the deepest furrow and Position 2 creates the shallowest furrow. Adjust this setting based on your soil conditions to achieve the optimum planting depth.

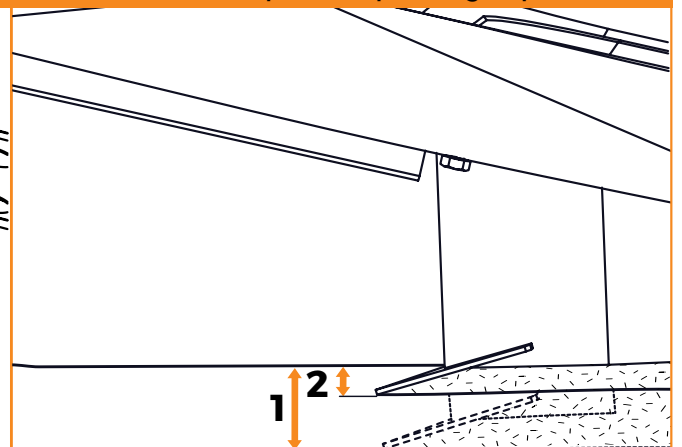
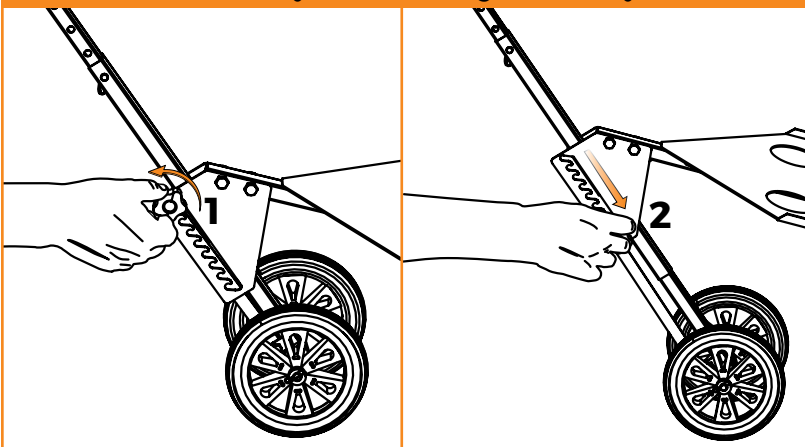



## STEP 5- Instal the Sweeps (7,8) and the Rear Wheels (9,10)

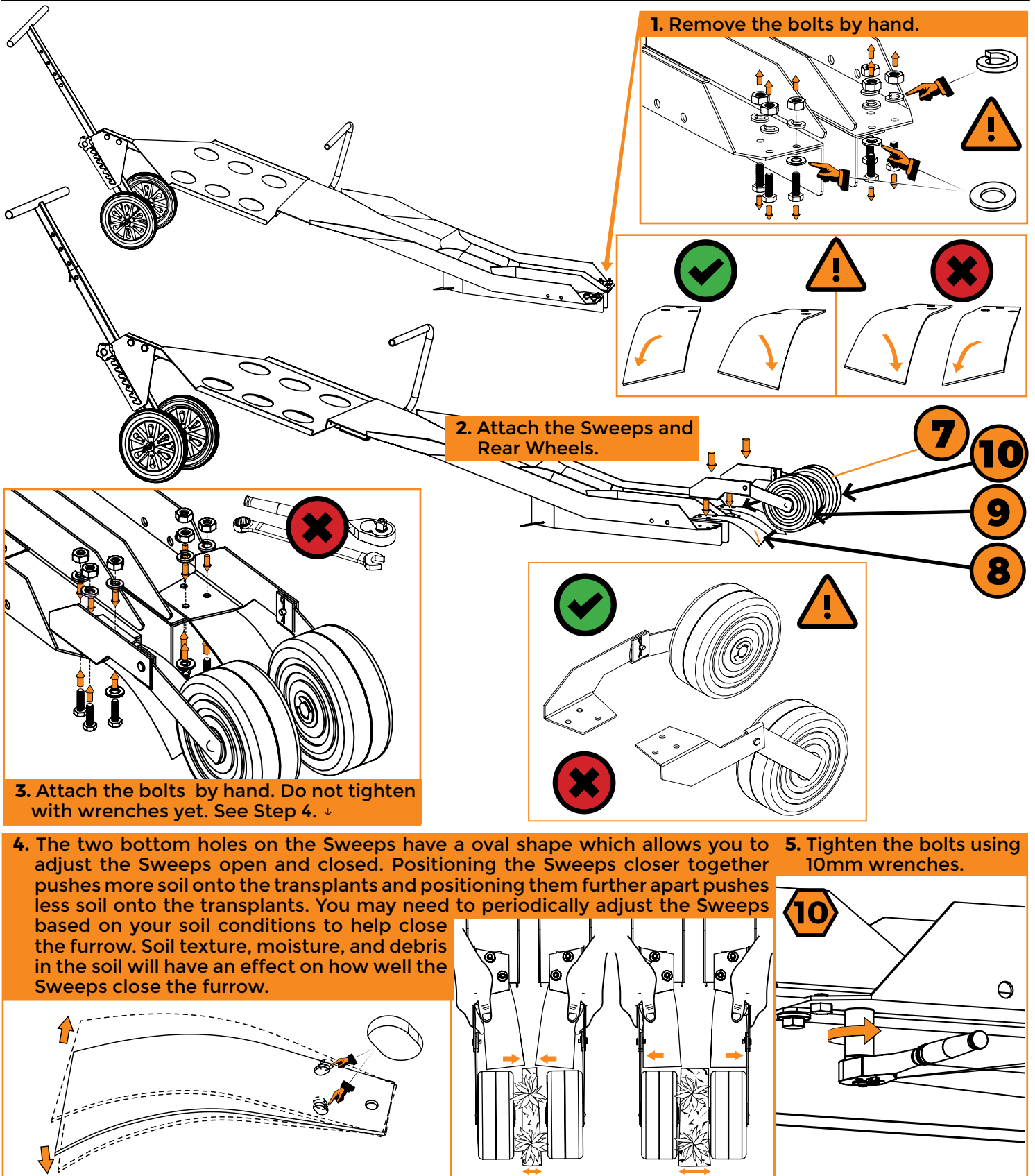



# Transport

When you want to move the Transplanter grab the Carry Handle (1) and the Pull Handle (2), pick it up (3) and then carry it from place to place. Do not drag it on the ground (4) because the Furrower (5) will dig into the ground.

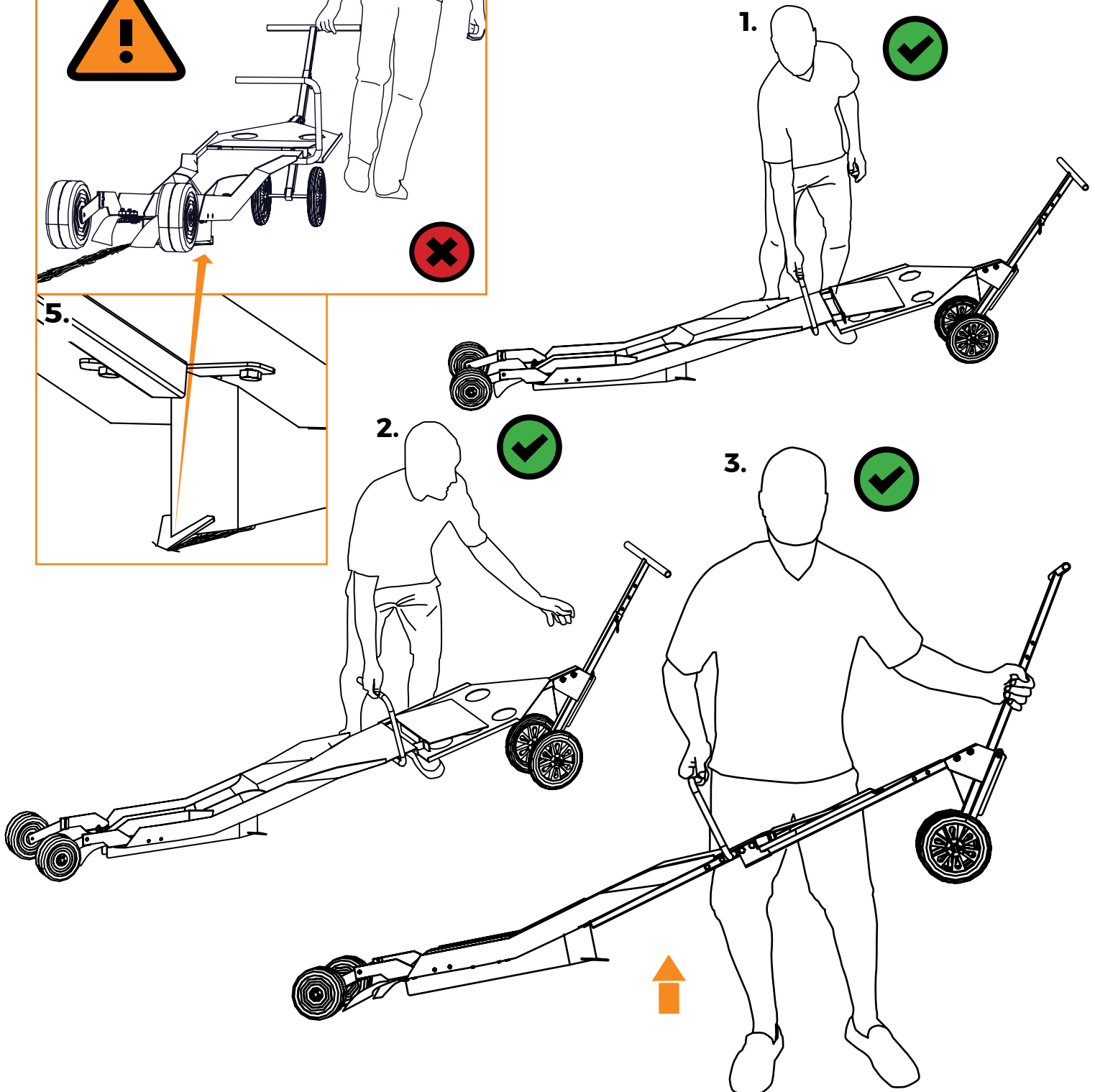
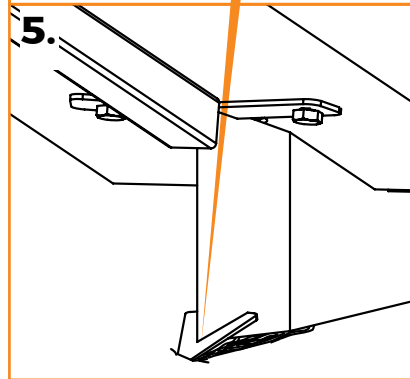
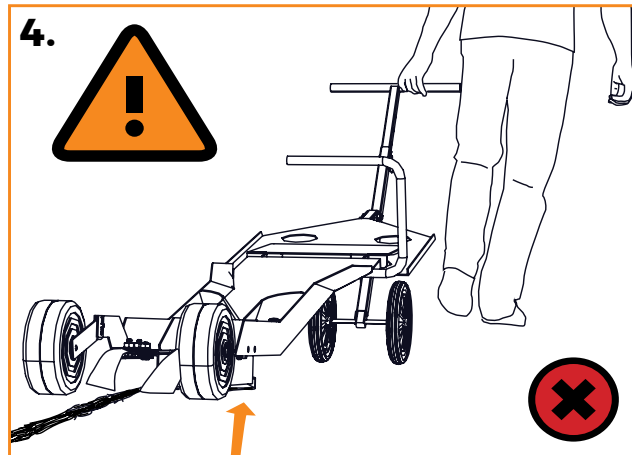

To learn how to use the Transplanter and make adjustments visit [paperpot.co/instructions](http://paperpot.co/instructions).